

MEETING MINUTES

Project	Roosevelt High School	Project No	PPS:ARCH 60117, BA: 13910
Subject	Design Advisory Group (DAG) #10	Meeting Date	1/30/2014
From	Joseph Echeverri, Bassetti	Date	2/5/2014

Attending

Michael Davis	Bassetti	Nate Buddress	Lease Crutcher Lewis
Joe Echeverri	Bassetti	Andrew Beyer	Lease Crutcher Lewis
Lorne McConachie	Bassetti	Mike Verbout	RHS DAG
Michelle Platter	PPS OSM	Kelsey Green	RHS DAG
Sarah Oaks	PPS OSM	Jo Lane	RHS DAG
Kimm Fox Middleton	PPS Communications	Catherine Theriault	RHS DAG
Dennis Phillips	Community Member	Jason Starman	RHS DAG
CJ Sylvester	PPS	Jenni Villano	RHS DAG
David Mayne	PPS	Abby Pasion	RHS DAG
Ken Fisher	PPS	4 Community Members	

Discussion:

1. Michelle gave an update on the schematic design process
 - a. 3D modelling of the design is ongoing
 - b. Investigation of existing building conditions is ongoing
2. A student transportation survey was dispersed and will be compiled soon. Results will be shared to the DAG in a future meeting.
3. Besides scheduled DAG and community workshops, separate meetings will be taking place with teachers, wrap-around service providers, and other district stakeholders.
4. Enhanced Electives discussion will be pushed forward via focus groups. Results of these focus group discussions will be forwarded to DAG members via email as they become available.
5. SPED will be focused on in discussions with teachers
6. Wrap-around services will be discussed with each provider. The Alumni Association would also be a good resource for information.
7. Lorne provided an overview of the current design, referencing the guiding principles that were developed through master planning. Input from the DAG on the major adjacencies within the new plan sketches would be helpful.
8. Michael provided an overview of the preliminary floor plan sketches.
9. Regrading will be done around the 1921 building, Auditorium building and commons to provide more natural daylight to the ground floor level.
10. The STEM location is currently near the West entrance. The question was raised to the DAG whether this location is good or bad, taking into consideration on-grade access, proximity to learning communities, and proximity to the commons and Maker's Lab.

Roosevelt High School
Design Advisory Group (DAG) #10
1/30/2014

- a. DAG members commented that better proximity of STEM to the Maker's Lab is desirable
 - b. The Maker's Lab should be closer to the stage, as sets and deliveries are large. Scenery is typically built from 4'x12' panels. Rentals for the theater also would come through the shop to the stage.
11. Choir space was raised as a question, and it was noted that there is no allotment in the program for a separate choir room. Currently, a choir program would share space with band.
 12. There are a number of art pieces, murals, etc. of student work that should be preserved in some way. Lorne mentioned that an option is to take high resolution photos and reproduce them as printed panels in the new school design
 13. Location of historical documents and images from the Heritage Room should also be considered in the new school. DAG members said it would be desirable to get them out in the public eye in a secure and appropriate manner rather than be isolated in a room.
 14. Conference space for large groups should be provided in the new school.
 15. DAG members requested that options for future expansion be shown in the floor plans
 16. A community member from PCC noted that flex spaces in their school, which were built about 6 years ago, became underused and converted to storage. It was noted that these spaces must be varied and teachers need to be trained on how to use these spaces as a supplement to their classrooms for best results.
 17. Joseph presented the community and student services adjacencies.

END OF MEETING 01.30.14 MINUTES

Next Meeting: 02/13/14

Attachments: Community Spaces and Student Services Presentation
Preliminary Floor Plans

Meeting minutes composed by: Joseph Echeverri, Bassetti Architects

Bassetti Architects believes these meeting minutes accurately convey the discussions and decisions that occurred during the meeting. These minutes will become part of the project record unless comments pertaining to the accuracy of these minutes are received from attendees within 5 calendar days of issuance of minutes.

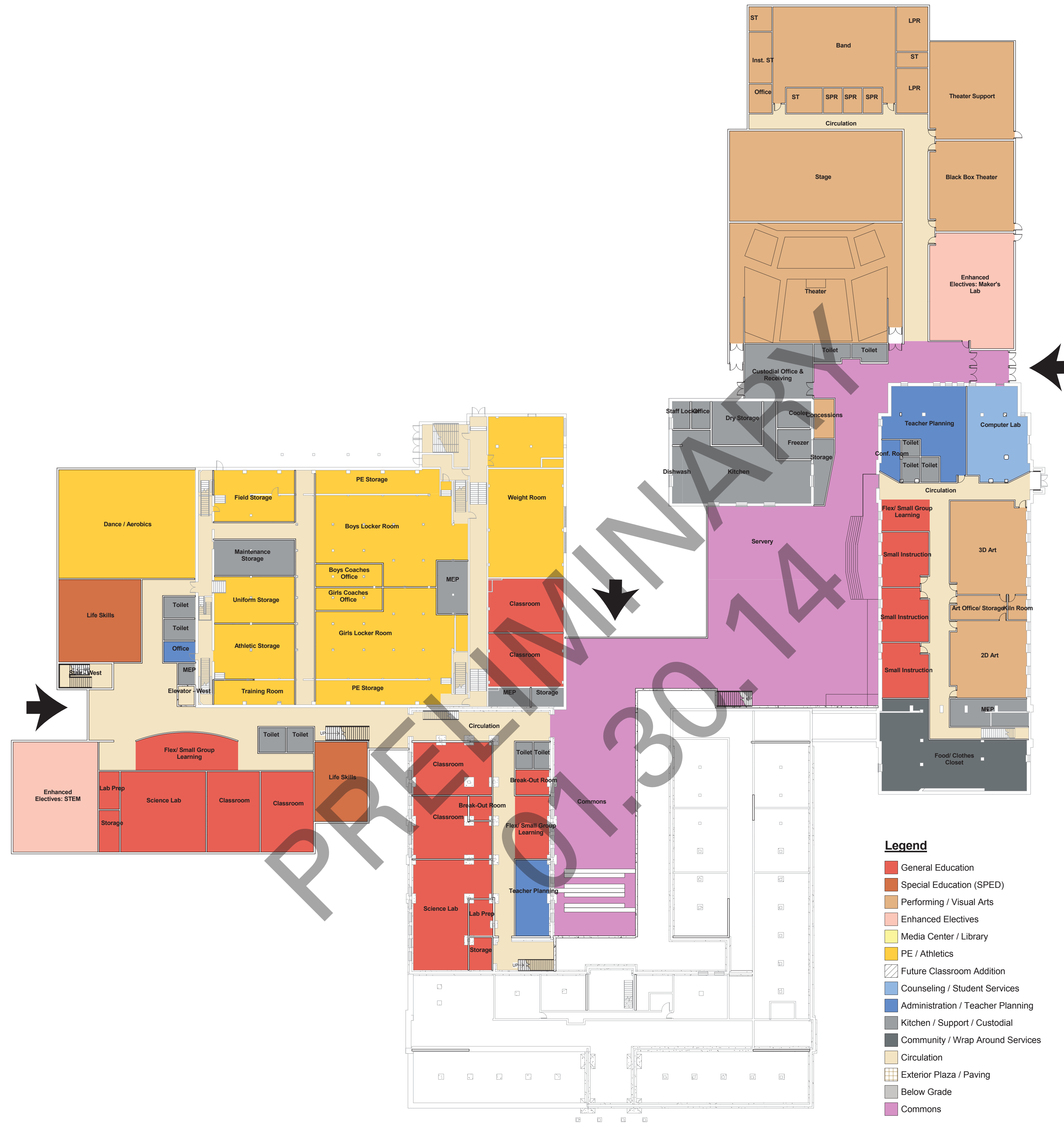

- Legend**
- General Education
 - Special Education (SPED)
 - Performing / Visual Arts
 - Enhanced Electives
 - Media Center / Library
 - PE / Athletics
 - ▨ Future Classroom Addition
 - Counseling / Student Services
 - Administration / Teacher Planning
 - Kitchen / Support / Custodial
 - Community / Wrap Around Services
 - Circulation
 - Exterior Plaza / Paving
 - Below Grade
 - Commons

GROUND FLOOR PLAN 0 8' 16' 32'

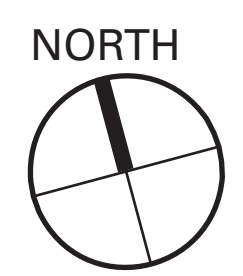

ROOSEVELT HIGH SCHOOL

SCHEMATIC GROUND FLOOR PLAN (1350/1700)

DAG Meeting: January 30, 2014

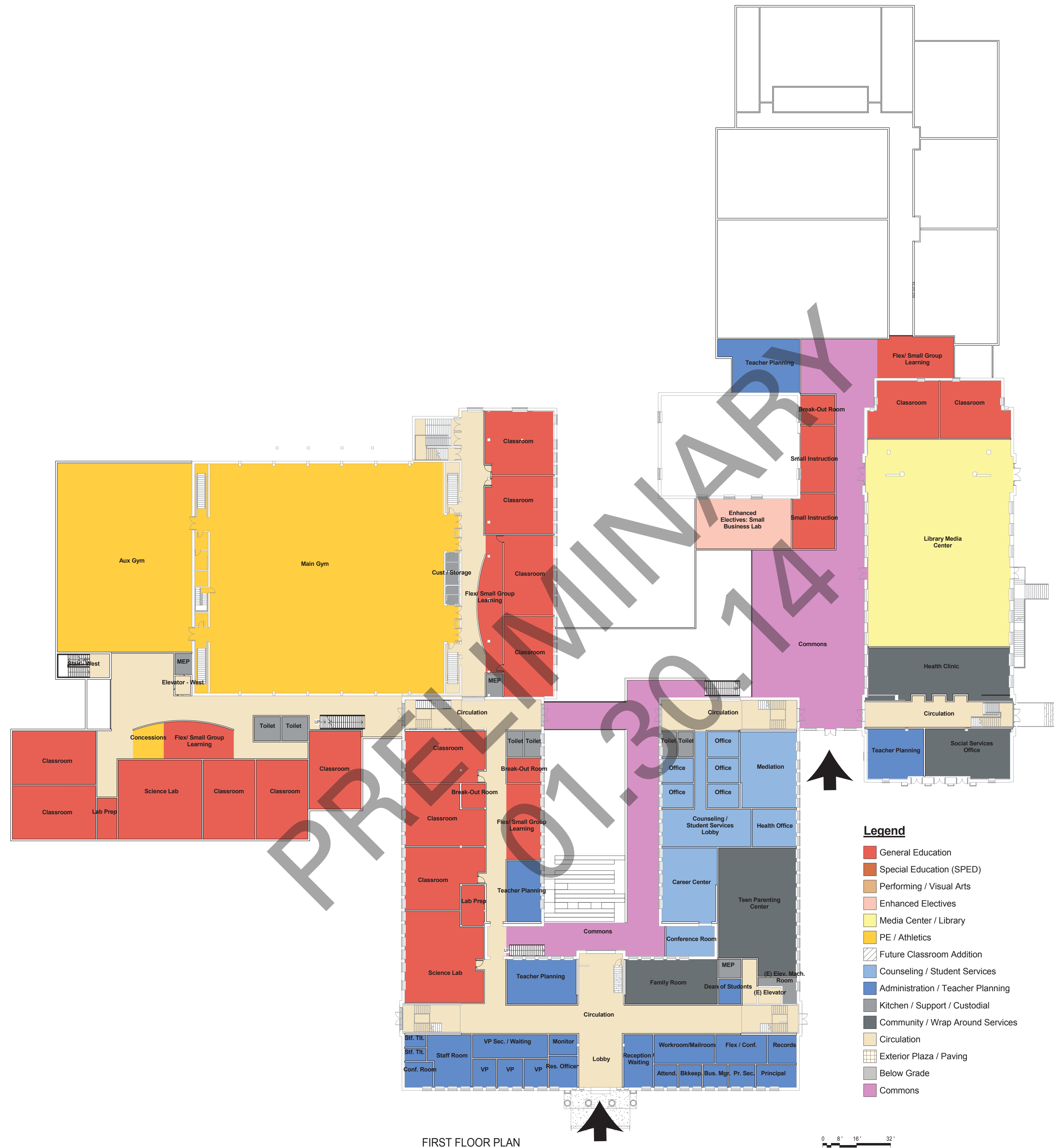

FIRST FLOOR PLAN

0 8' 16' 32'



ROOSEVELT HIGH SCHOOL

SCHEMATIC FIRST FLOOR PLAN (1350/1700)

DAG Meeting: January 30, 2014

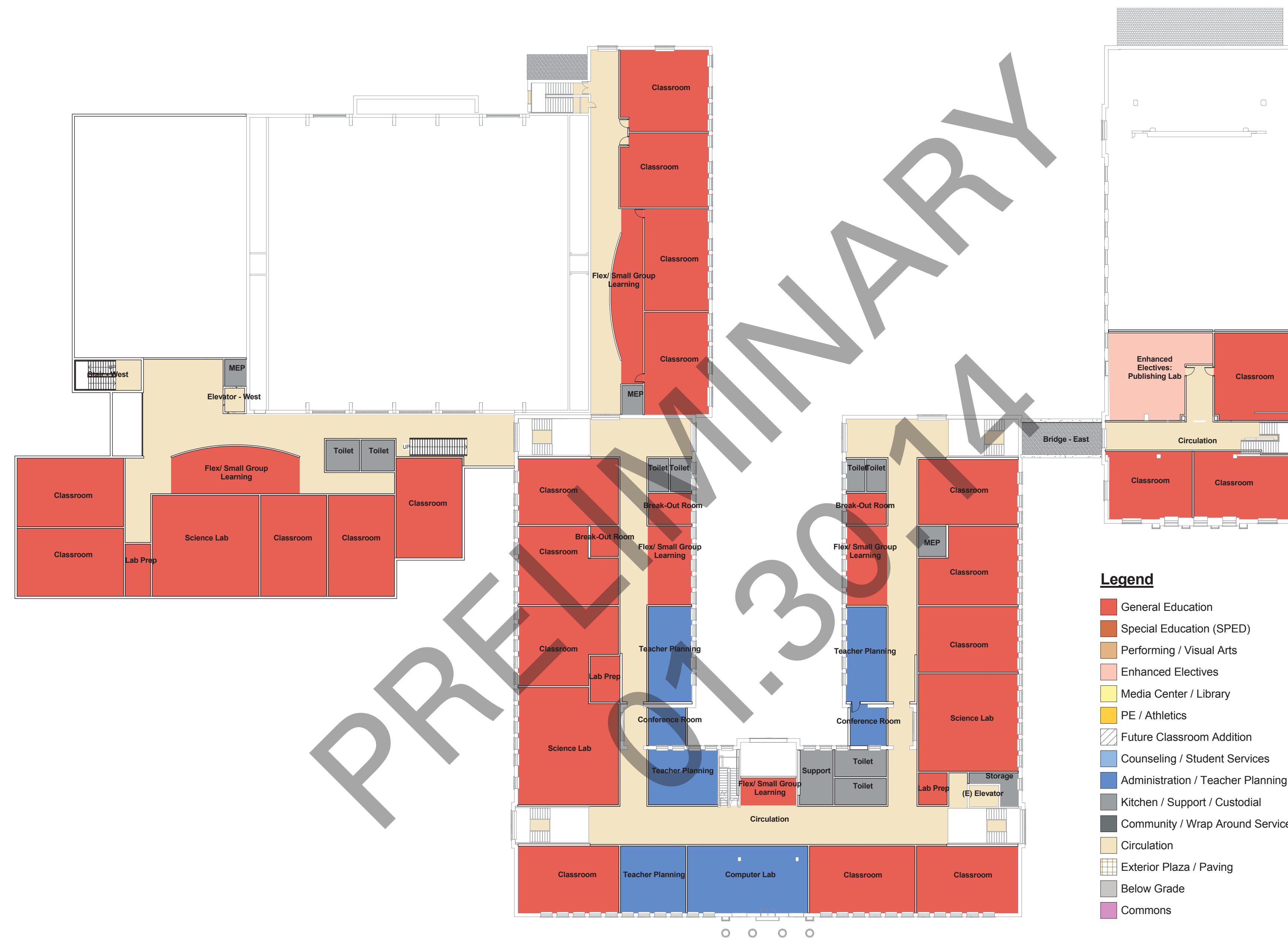

SECOND FLOOR PLAN

0 8' 16' 32'

ROOSEVELT HIGH SCHOOL

SCHEMATIC SECOND FLOOR PLAN (1350/1700)

DAG Meeting: January 30, 2014



Existing Plan

Ground Floor

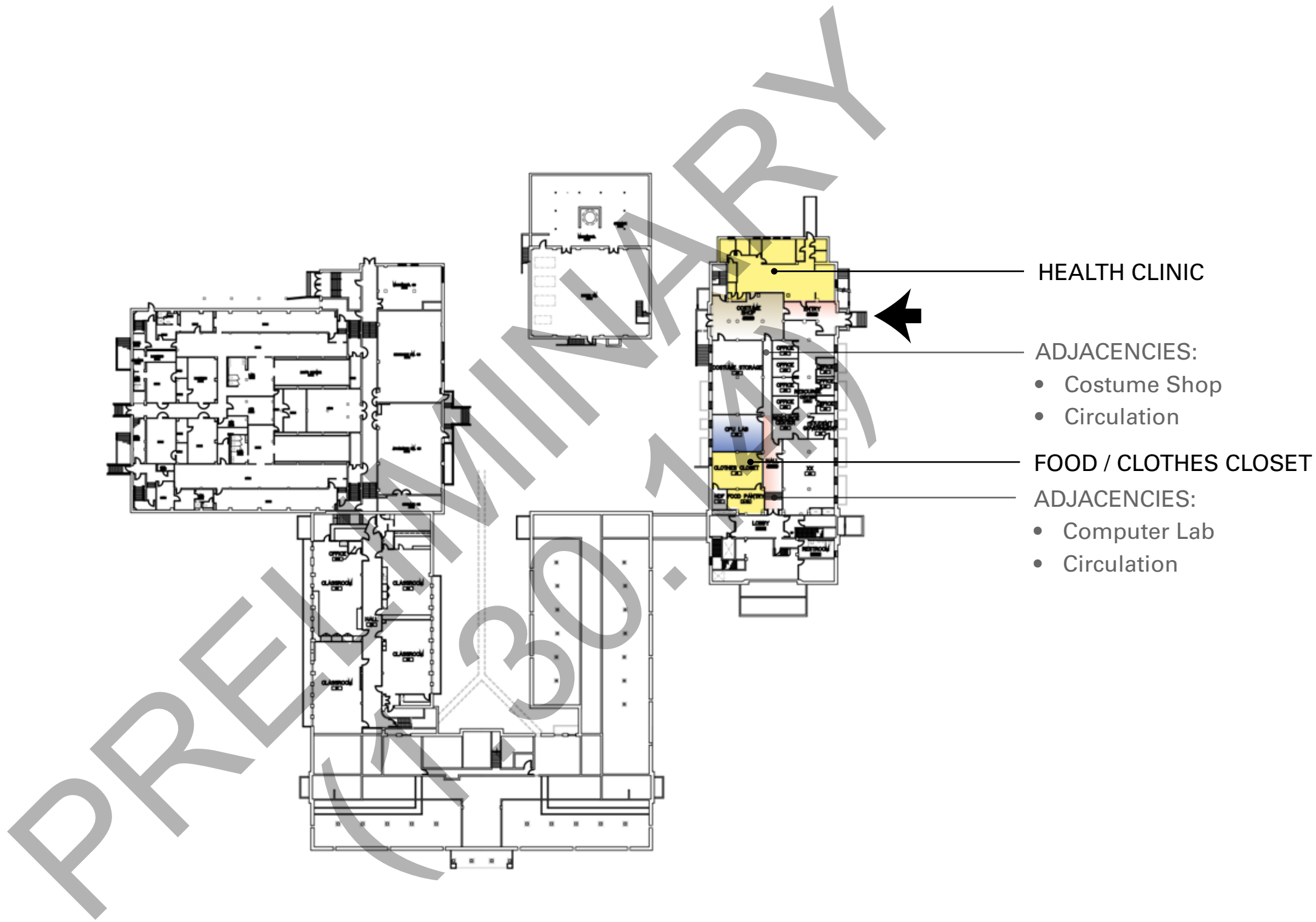

Existing Plan

First Floor

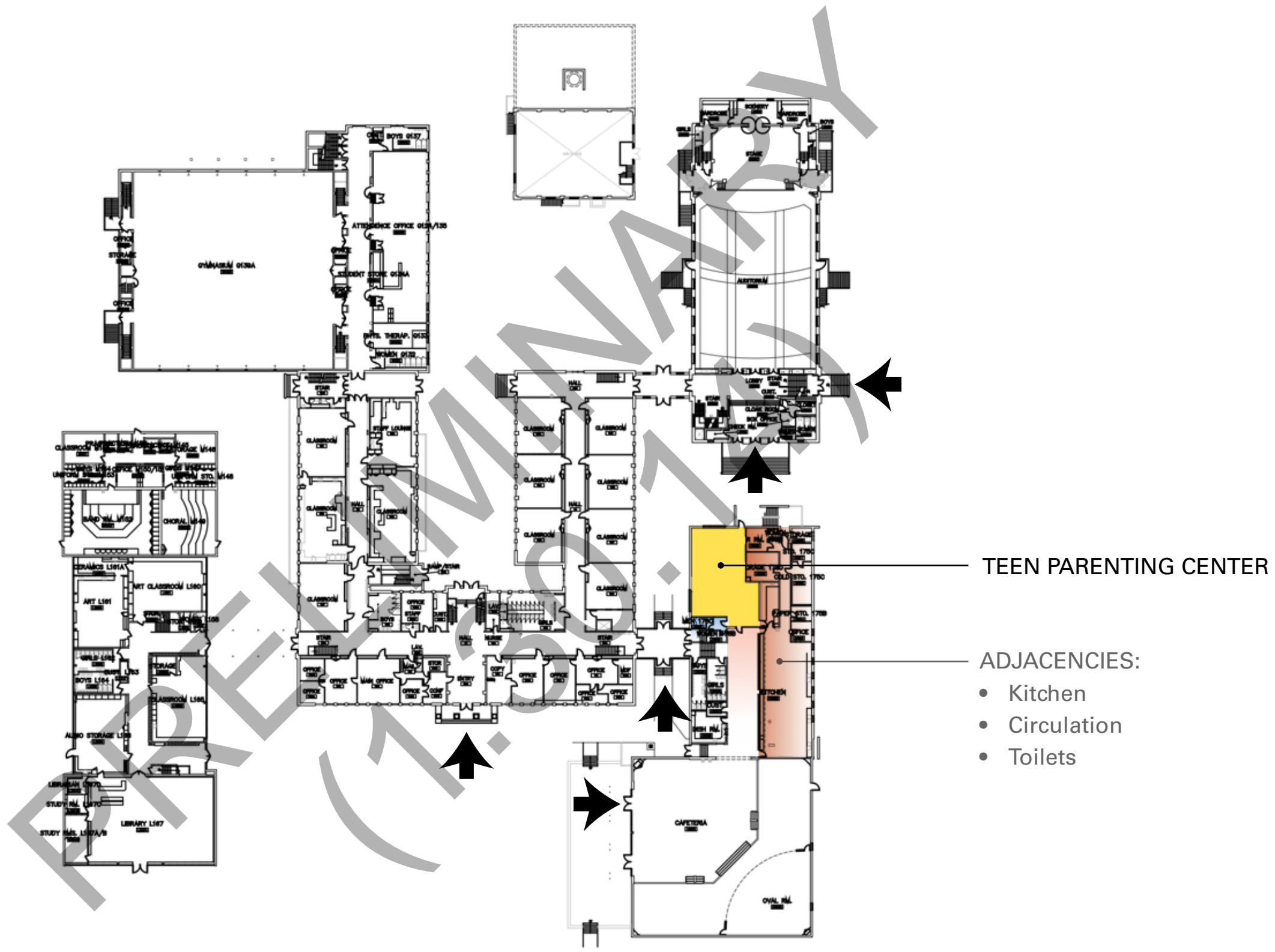

Existing Plan

Second Floor

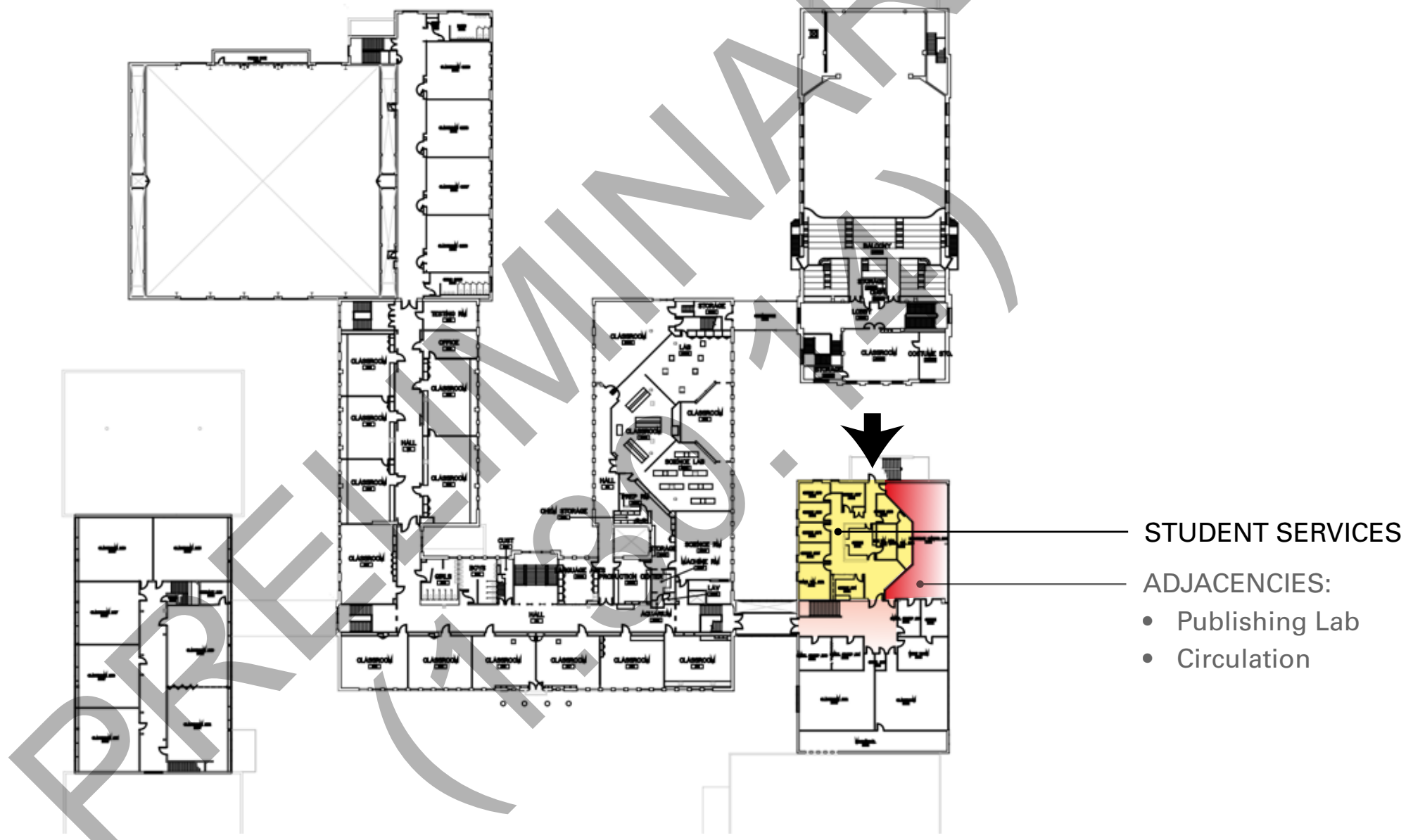

Proposed Plan

Ground Floor

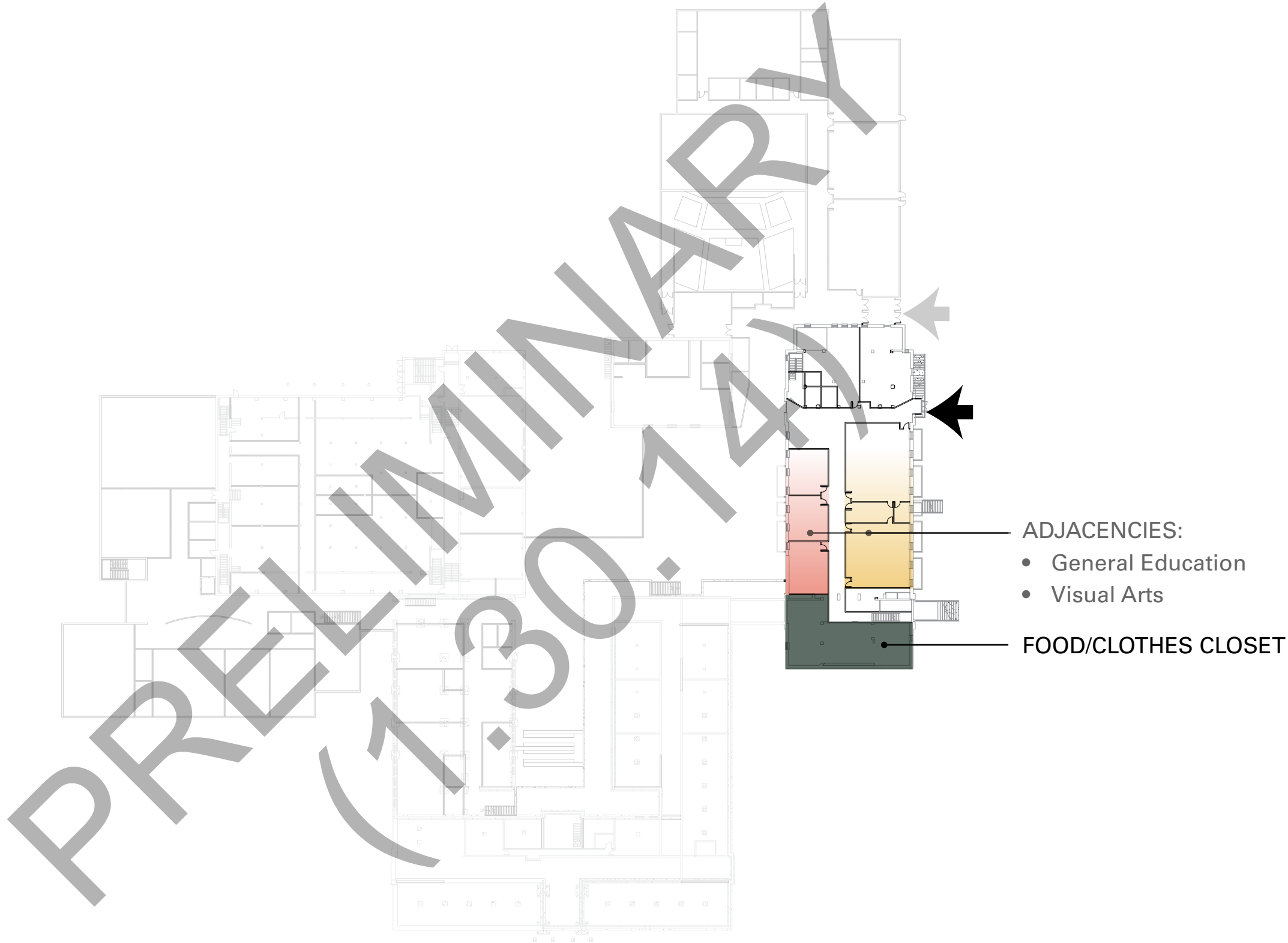

Proposed Plan

First Floor

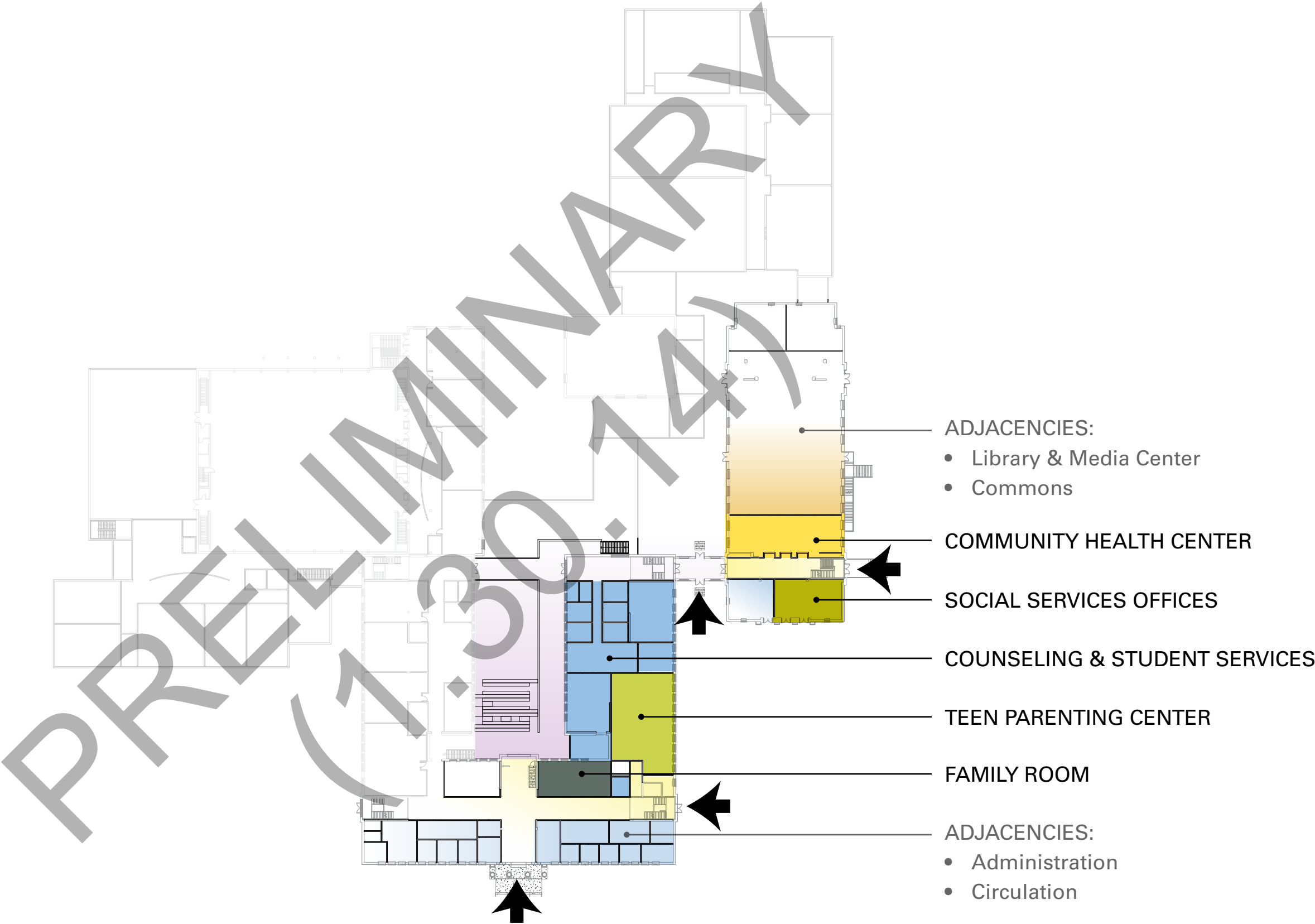

Health Clinic

- Current Area: 1900 SF
- Proposed Area: 1600 SF

Teen Parenting Center

- Current Area: 1735 SF
- Proposed Area: 2100 SF

Food & Clothes Closet

- Current Area: 835 SF
- Proposed Area: 2000 SF

Counseling and Student Services

- Current Area: 2670 SF
- Proposed Area: 4155 SF